

Sweet Pea



165' (50.29 m) FEADSHIP

LOA:	165' (50.29 m)	Year:	Mfg-2000 Model-2000
Beam:	32' (9.8 m)		Refit-2008
Draft:	Min 7'9" (2.4 m) Max 8'5" (2.6 m)	Mfg:	FEADSHIP
Speed:	15 knots @1500 rpm / 16.5 knots @1625 rpm	Type:	Motor Yacht
Location:	Savannah, Georgia, United States		Displacement
		Price:	39,500,000 USD

Additional Specifications For Sweet Pea:

LOA:	165' (50.29 m)	Year:	Mfg-2000 Model-2000
Mfg. Length:			Refit-2008
Beam:	32' (9.8 m)	Mfg:	FEADSHIP
Draft:	Min 7'9" (2.4 m)	Model:	Van Lent hull #783
	Max 8'5" (2.6 m)	Type:	Motor Yacht
Hull Mtrl:	Aluminum		Displacement
Hull Cnfg.:	Full Displacement	Top:	With Flybridge
Hull Designer:			Enclosed
Deck Mtrl:	Teak	Speed:	15 knots @1500 rpm /
Disp:	522 tons		16.5 knots @1625 rpm
Range:	5000	Engines:	2xCaterpillar
Int Designer:	Donald Starkey		3512 B DI-TA
Ext Designer:	DeVoogt International		1500 HP , 8010hrs
	Ship Design	Engines Year:	1998
Fuel Cap:	20087 g (76030 l)	Staterooms:	6
Water Cap:	6604 g (24996 l)	Sleeps:	12
Holding Tank:		Heads:	
Flag:	Cayman Islands	Crew Quarters:	
Classifications:	Lloyd's	Crew Berths:	10
Class Type:	A1 Yacht G6 Mono ,	Captain Cabin:	Yes
	LMC	Price:	39,500,000 USD
MCA:	Yes		
ISM:			
Location:	Savannah, Georgia, United States		

Remarks

SWEET PEA formerly **BLUE MOON** was purchased by her present owners in May 2006 and since that time has undergone two extensive refits. During the first refit the AV system and communications were upgraded, the soft furnishings in all guest areas and sky lounge were replaced. A new Quantum zero speed stabilizing system and three new 145 Kw Northern Light generators were installed, this combined with new exhausts and re-wiring of the entire power management system. This improved the vessel stability and also made for a much cleaner running vessel.

During the second and most recent refit from November 2007 thru March 2008 the vessel was completed repainted, the forward mast was removed and replaced with an air operated mast (for use only when necessary). The master stateroom soft furnishings were replaced and master bathroom remodeled in white onyx. All overhead materials as well as the main salon and dining

room soft furnishings were replaced. The exterior awnings and exterior cushion covers were also replaced.

The entire engine room was repainted, the main engines rebuilt (the engines hours are +/- 50 hours), new water makers installed, the black water pumps replaced and the system improved. The Air Conditioning system was rewired, gauges replaced and new frequency drives and blowers installed. The aft passarelle was completely removed and rebuilt. A Lathe was also added to the engine room.

The third and last refit was completed in Seattle where the new VSAT system was installed as well as the stabilisers removed and rebuilt by Quantum. The main sea chests were removed and serviced and engine room coolers rebuilt

In short SWEET PEA has been brought back to the premium shape that a vessel of her pedigree should be kept in.

SWEET PEA is respected as one of the world's best looking and most preeminent Feadships and most likely one of the quietest. At full speed the noise in the main salon above the engines is only 55dbA and only 46dbA in the guest cabins!

Her original build captain and specification were very detailed, and it shows throughout this most capable yacht which can safely cross the ocean and also cruise the shallow waters in the Bahamas.

Sweet Pea has a full width Owner's Stateroom, four Guest Staterooms that can be opened to form two VIP Staterooms, and one Guest Cabin that can also be used as a Nanny Cabin or for staff.

There are four double Crew Cabins in addition to the Captain's Cabin.

Her shallow draft allows her access to places normally prohibitive for a yacht of her size, and her excellent beam and rolling chocks allows for great sea kindly motion and stability at sea. Stability at anchor is achieved by the well proven Quantum stabilizers with at anchor stabilization, making her a delightful platform when other similar sized yachts are uncomfortably rolling.

With an exterior and interior design by the highly acclaimed Don Starkey, SWEET PEA is pedigree personified.

She carries two good sized tenders behind her wheelhouse, thus clearing all the decks for more exterior dining, lounging spaces, and owner's privacy.

. The aft passarelle was completely removed and rebuilt. A Lathe was also added to the engine room.

The third and last refit was completed in Seattle where a new VSAT system was installed as well as the stabilizers removed and rebuilt by Quantum. The main sea chests were removed and serviced and engine room coolers rebuilt.

Main Deck

Donald Starkey designed the Main Deck for easy flow of the crew and the guest and it consists of the Bosuns locker, Owner's Suite, Owner's Office, Gym, Main Lobby, Dining Saloon, Main Saloon, Galley, and the Aft Deck.

The full beam *Owners suite* has a king size bed, ensuite white Onyx bathroom with large shower, a full entertainment system with surround sound, vanity table, generous closet space and a sitting area to starboard. All windows are equipped with electrically operated night blinds and screens.

Further aft on the starboard side is the *Owner's office*. Very well laid out, this space is light and airy and is connected to the Owner's gymnasium.

The *gymnasium* is well equipped and can be accessed by guests from the starboard passageway.

The main deck *galley* is to port, well laid out with excellent equipment, and access to the crew passageway or the main deck. Freezers and refrigeration are located near the crew passageway.

A serving *pantry* is aft of the galley for service to the dining room.

The special Starkey designed stairway, from the accommodation deck to the bridge deck is located in the vestibule with inlaid marble floor. The main deck *powder room* is also located here.

The *dining saloon* has extensive storage cabinets on both sides, forward and aft.

Aft of the Main foyer and the *galley* is the *dining saloon* with its large windows and paneled walls. There are specially designed cabinets for china, silverware and crystal on the port and starboard side, as well as forward and aft.

The dining saloon has special Starkey designed expanding table, seating from 6 to 12 people.

The *main saloon* is separated from the dining saloon by a low credenza which gives the feeling of space; however it can be shut off from the dining saloon by a series of special designed shutters and doors.

The electrically operated Venetian blinds are the same as in the dining saloon.

There is an arrangement of free standing furniture where social events and TV viewing can take place.

The *aft deck* is delightful with a wet bar forward to the port side, room for a dining table with

chairs, and C shaped seating aft around a coffee table.

Access down to the generous *swim platform* is via a starboard side staircase.

The *passarelle* accesses on the port side.

Wing doors and sliding glass screens protect the aft deck from wind making outside dining possible even in windy conditions.

Lower Deck

Crew Quarters:

Forward are *two crew cabins* with upper and lower berths and ensuite baths with showers.

Two *additional crew cabins* are further aft, each with (2) lower berths, desks between and ensuite bathrooms.

The *laundry* is to starboard, and the comfortable *crew mess* is to port.

There is an additional *stateroom* in this area, with a single berth and Pullman berth that is ideal for guides, security personnel, children, nanny, guests or crew. It is finished identically to the rest of Sweet Pea's guest suites and has a marble en suite bathroom with shower. Access is from either the forward stateroom area or from the crew area.

Guest Accommodations:

There are *four guest suites* ideally located in the central part of the ship.

The two forward guest suites and two aft guest suites each have sliding doors so they can be open to make 2 two large VIP suites.

Two guest staterooms have queen beds, and en suite bathrooms with tubs and showers. Two additional guest staterooms have twin beds that can be arranged in various settings with ensuite bathroom and showers.

The central *guest lobby* is at the foot of the staircase. It has a wet bar for guests, a steam room and a full sauna.

Bridge Deck

In front of the *wheelhouse* is a patio with settee table and teak deck stairway to the fore deck.

The wheelhouse is exceptionally well laid out with forward facing settee and table to port, and navigation and communication area to starboard.

The *captain's office* is behind the wheel house on the port side, and the *captain's stateroom* is

on the opposite side of the office on the starboard side.

The captain's stateroom is furnished with queen berth, settee, extensive locker space and adjoining bathroom. This Captain's cabin is superbly arranged and is equipped with 26' Flat screen TV, DVD/CD, Security Camera display, Alarm Monitor, B&G Hydra 2000 display and VHF Radio.

A *pantry* is behind the ships office on the port side, equipped with Espresso coffee machine, ice maker, refrigerator and dumb waiter.

A *powder room* is opposite to starboard, and a central staircase down to main deck is in the lobby area. Tenders are stored behind the wheelhouse, port and starboard sides, with a door accessing the starboard side tender bay from the lobby.

The *sky lounge* has a sit down bar equipped with Ice maker and refrigerator, and entertainment center with 42" screen TV. There is a comfortable settee, marble coffee table's and easy chairs and a game or breakfast table. Large glass windows provide lovely light and glass electrical doors with insect screens leads out to the *covered dining area*.

The bridge deck aft is excellent for dining, recreational and as a lounge area. There are two "C" shape lounges with high and low tables with a cabinet between that has a barbecue grill, refrigerator, ice maker and storage. There are two teak movable tables that can sit 4 to 12 people, and a dining table for 12.

The area has sliding windows on lateral fashion plates which act as a windbreak, in addition to the glass doors on both port and starboard sides.

The bridge deck aft is sheltered by the overhang of the sun deck but also has a soft awning to completely cover this area.

Sun deck

The extremely large sun deck with teak flooring has a complete wet bar with barbecue grill, ice maker, refrigerator, dumb waiter, Jacuzzi and sun bed.

The design of the arch is such to provide a shaded area for the bar and sitting areas, there is also a removable awning and just aft of this there is a small crane hidden in the bulwarks for launching the MCA rescue boat.

Galley/Laundry

- China storage
- Galley utensils, etc.
- Fully equipped commercial grade galley with center island design and forward and aft pantries Vulcan 6-burner stove with 4 sq. ft. grill

- 1 basket deep fryer, flat top grill, microwave, Salamander broiler
- Grone Steam Combi Oven - Replaced December 07
- CO2 fire protection in stove hood
- Electrolux refrigerator
- Insinkerator compactor x 2 - Replaced December 07
- Hobart Commercial dishwasher - Replaced December 07
- Hoshizaki icemaker - Replaced December 07
- Dishwasher - Replaced December 07
- Brewmatic coffee system (double pot)
- Jenn-Aire wine cooler 32 bottles
- Waring slicer
- (2) Hobart commercial disposals
- Kitchen Aid mixer (12 quart)
- Separate washing machine, ice maker and refrigerator in the Pantry
- Walk-in freezer and walk-in refrigerator on crew deck.

The crew galley has a microwave oven, (2) refrigerators, dishwasher, sink and coffee maker.

There is a gas char broiler BBQ grill on the boat deck and a cook top and microwave in the upper deck pantry. Aft deck refrigerator and icemaker. Refrigerator, icemaker and trash compactor in sky lounge bar. A dumbwaiter serves the main galley and the upper deck pantry also with a refrigerator, icemaker and espresso coffee machine.

Laundry:

Forward laundry with (1) Miele Professional washer, (1) Whirlpool Professional washer, and (2) Miele Professional dryers
 Miele Roller iron
 Professional Steamer

Engine room

The *Engine room* is aft of the guest accommodations and the three generators are located in two separate sound proof rooms.

The air conditioned *engineers office (Control Room)* has a 180 degree view from engine room, and contains the electrical main panel and all the monitor and alarm systems.

The *lazarette* is behind the engine room, where the shore power connections, Atlas converter and the water toys are located. There is space for three wave runners which are launched by an overhead crane from the transom door.

There is a full *Bosun's locker* on the main deck.

Construction

With the original design brief requiring a shallow draft yet stable and capable world cruising

yacht proving a challenge to many shipyards, Feadship Royal Van Lent built the largest aluminum yacht ever when they completed SWEET PEA. She was built to Lloyd's class and was the first aluminum yacht built to the MCA Code of Practice.

Sweet Pea's hull form was extensively tested at the famous Marin Institute in Holland before construction, to confirm she would be a safe, stable, comfortable and sea kindly yacht.

Sweet Pea's shallow draft allows her access to places that normally only smaller vessels can navigate, as her original commissioning owner was adamant that he wanted to access the Bahamas and the Pacific Islands, and so SWEET PEA was born.

She benefits in not only her interior space from her actual 31' beam, but is incredibly stable at anchor even normally, but even more profoundly so when her zero speed stabilizers are activated.

Deck & Hull Equipment

- (2) Overhead cranes, 1500kg each, per beam, for tender launching
- 1 Gantry crane , 350kg in Lazarette
- (1) 650 Kg crane on the sundeck for MCA rescue boat
- (2) 25-man RFD life rafts in canisters
- (2) Electric Steen Windlasses with chain stoppers
- (2) Electric warping capstans
- (2) POOL type anchors 430 kg, flush mounted
- 450' chain each side
- Mooring lines
- Hydraulic passarelle, port side, aft deck
- Marquipt 9-step sea stair with 3 steps extension
- Sundeck Jacuzzi
- Swim platform shower
- Anchor ball
- Ship's bell
- Clock, Barometer, thermometer, inclinometer
- Boat hooks
- Cylindrical fenders

Mechanical Equipment & Engine Details

- Two Caterpillar 3512 Electronic (B) DI-TA's @ 1500 hp w/rebuilt Top End, Raw Water Pumps, Fuel Coolers, Heat Exchangers with 8010 Hrs at **March 2008**.
- N R Koeling chilled water air-conditioning (fan coils) - system upgraded new blowers, new frequency drives, completely re-wired and upgraded gauges - **March 2008**
- Frequency controls on air-conditioning compressors - replaced **March 2008**
- Oil bath shafts
- Jastram (BU2845) electric bow thruster (85) with variable speed Anschutz pilothouse and wing controls

- CO2 fire control system in engine room
- (2) fire pumps in engine room and emergency diesel pump in bow thruster room
- Thorne fire monitoring system
- 105 gallons hot water storage
- (2) Matrix water makers with 4,400 gallons per day (each) capacity - replaced **March 08**
- DVZ oily water separator - rebuilt **March 2008**
- Alpha Laval fuel centrifuge
- Manifold bilge pumping system for all interior spaces and separate electric pumps for lazarette and forepeak
- Cupro nickel piping on all raw water
- Raw water piping protected by Cathelco system
- Quantum Zero Speed Stabilizers with digital control on bridge - **Dec 2007**
- Custom Feadship anti roll tank
- Bilge keels
- Variable speed and reversible engine room fans on frequency drives
- Simon monitoring system - **Dec 2007**
- EVAC heads and treatment system - Hamman black water treatment - upgraded pipe work and pumps **March 2008**
- VEGA/Headhunter tank gauges
- ZF gear boxes w/ reverse reduction 3.5:1 ratio - rebuilt **March 2008**
- Marioff Hi-Fog system in all areas throughout vessel
- Extensive inventory of spare parts
- Pressurized deck wash system
- Diesel tender refueling station in aft peak
- Grizzly 6003 Lane

Electrical System

- 208/380 3-phase AC 60 hz (U.S. requirements)
- (2) Atlas 60 kVa units (total 120 kva) converting any local current to the ship's requirements
- (3) Northern Light 145 kw Generators - Stbd - 4000 hrs, Center - 4000 hrs, Port - 4000 hrs all replaced December 2006
- All Generators have water drop muffler system, two are capable of exhausting thru the stack or overboard - exhaust systems replaced December 2006
- All generators mounted in two separate generator rooms
- Auto parallel and load sharing on generators - completely rewired December 2006

Seamless shore to generator and generator to generator transfer, rewired December 2006

Tankage

Fuel: 20,087 US Gallons (76,040 litres)

Water: 6,604 US Gallons (25,000 litres)

Lube Oil: 570 US Gallons (5,010 litres)

Sludge: 2075 US Gallons (4,290 litres)

Curtis Stokes & Associates, Inc.

1323 SE 17th Street Suite 168 Fort Lauderdale, Florida 33316 United States
 Contact: Curtis Stokes, Phone: +1.954.684.0218, Email: curtis@curtisstokes.net
 URL: <http://www.curtisstokes.net/>

Sweet Pea
 Page 9

Electronics & Navigation

- AIS system (2004) complies with new ISPS rules
- Anschutz Nautopilot D with (2) Anchutz Gyrostar gyros
- Furuno black box color depth sounder
- (2) Furuno 21 X band ARPA Radars interfaced to Transas
- Panasonic PABX Intercom system
- Sailor 250 watt SSB
- (3) Sailor VHF Multi-Station radios
- (4) Nauticomp Glass Bridge Displays - replaced **December 07**
- Sailor GMDSS station
- Furuno Weather Facsimile Recorder
- (2) Transas (separate systems) with chart table master and bridge slave as an option
- Full Burglar security alarm system including mats, cameras, infra-red beams, stress pads and doors contacts
- (2) Philips/ Leica GPS, Both interfaced with the 2 GPS.
- B&G Navigation Environment System
- Walker Doppler log
- Sat Com C
- Linkscape VSAT - Installed September 08
- Nera Saturn B Sat Com System with voice, fax and Hi-Speed Data (56k)- upgraded **March 08**
- Motorola Cellular via PABX Telephone System
- Sony Ericson GSM via PABX
- (12) portable UHF crew radios
- Security system closed circuit TV cameras with motion sensors
- Hewlett Packard copier and fax
- (6) Standard handheld VHF's
- Standard VHF base station with DSC and repeater in Captain's Office - There are 2 master VHF's and 2 slaves in addition to the DSC unit (bridge - captains cabin, crew mess and lazarette)
- Raytheon Loudhailer

Audio & Visual Equipment

- Sea Tel 4004 DAC 2200 Sat TV for worldwide capability - replaced **Dec 07**
- (8) Sea Tel receivers

Owner's Stateroom:

- Pioneer 42' Flat Screen TV
- NAD DVD / CD player
- Sony Satellite receiver
- RTI remote control

Gym:

Curtis Stokes & Associates, Inc.

1323 SE 17th Street Suite 168 Fort Lauderdale, Florida 33316 United States
Contact: Curtis Stokes, Phone: +1.954.684.0218, Email: curtis@curtisstokes.net
URL: <http://www.curtisstokes.net/>

Sweet Pea
Page 10

- Sony 32' Screen TV
- NAD DVD / CD player
- RTI remote control

Main Salon:

- Pioneer 42' Flat Screen TV -
- NAD DVD / CD player
- Sony Satellite receiver
- RTI remote control

Aft Starboard Stateroom:

- Sony 27' Screen TV
- NAD DVD / CD player
- RTI remote control

Forward Starboard Stateroom:

- Sony 27' Screen TV
- NAD DVD / CD player
- RTI remote control

Aft Port Stateroom:

- Sony 27' Screen TV
- NAD DVD / CD player
- RTI remote control

Forward Port Stateroom:

- Sony 27' Screen TV
- NAD DVD / CD player
- RTI remote control

Sun Deck:

- Sony 22" Screen TV
- Sony Tuner & Amplifier
- Sony 5 disc CD player
- Sony VCR + Creston remote control

Boat Deck Bar:

- Pioneer 42" Flat screen TV
- Sony 5 CD / DVD player
- Sony Tuner & Amplifier
- Sony Satellite receiver
- RTI remote control

Captain's Stateroom:

Curtis Stokes & Associates, Inc.

1323 SE 17th Street Suite 168 Fort Lauderdale, Florida 33316 United States
Contact: Curtis Stokes, Phone: +1.954.684.0218, Email: curtis@curtisstokes.net
URL: <http://www.curtisstokes.net/>

Sweet Pea
Page 11

- Samsung 26' Flat Screen TV
- NAD DVD / CD player
- Sony Satellite Receiver
- RTI remote control
- VHF Radio
- Security System Screen Display
- B&G system display
- Simon Alarm system Monitor

Chief Engineer's Cabin (Port Aft):

- 27' Flat screen TV
- Sony Tuner / Tape deck
- DVD and Video machine
- Simon Monitoring System

Deck Crew Cabin (Port Fwd):

- Sony Tuner / Tape deck.

Stewardess Cabin (Stbd Fwd):

- Sony Tuner / Tape deck

First Mate Cabin (Stbd Aft):

- Sony Tuner / Tape deck.
- DVD and Video machine
- Flat Screen TV

Crew Mess:

- NEC 42" Flat Screen TV
- NAD DVD / CD Player
- Sony Satellite Receiver
- SIMON Alarm system Monitor
- Security System Screen Display
- Fire Alarm control / display

Galley:

- Sony Tuner &Tape deck / CD player

Control Room:

- Sony Tuner &Tape deck / CD player.

IT Systems

Central ships server with wireless network to Ship's Office, Captain's cabin, Skylounge and Crew Mess. Wired network to Owner's office, ECR and Engineer's Cabin.

Every cabin (crew and guests) has RJ45 plugs to access the network via Ethernet card system

High speed data throughout network on Sat Com B at 56 kps.

Tenders, Toys & Dive Equipment

- (1) Novurania 19' Launch RIB with 4 cylinder Yanmar Diesel Inboard and Mercruiser Stern Drive -**2006**
- (1) Cherubini 20'Fiberglass and Wood Tender with 6 cylinder Yanmar Diesel Inboard and Mercruiser Stern Drive -**2006**
- Fountain 33 SFC - 2 x 275 hp Mercury outboard - New **March 08**
- MCA rescue boat - September 08
- (1) Hobie Wave Sail Boat
- (2) Kayaks
- Bauer dive compressor, also fills fire breathing tanks
- Selected scuba gear
- Water skis
- Various water sport toys, tubes, etc

Safety and Fire Protection

Marrioff Hi Fog pressurized sprinkler system throughout with Tyco controls. Engine room CO2 suppression system. Additional heat and smoke sensors in all overhead void spaces with easy and fast access to all junction boxes, transformers or any other electrical source.

Fire Protection System:

- Hi Fog System Marrioff
- Fire Doors
- Fire Hose & Nozzle
- Fire Pump with Turn on/off switch on the Bridge
- Fire Extinguisher (Chemical Powder, CO2) - 26 in total
- Fire Hydrants
- Fire Blanket for grill AND Galley
- Smoke Detectors
- Heat Detector above overhead
- Fire and General Alarm
- (2) full Breathing Apparatus with 2 extra Bottles
- Emergency lights

Wheelhouse:

First Aid Kit

Hand held search light

(2) Jotron 9 GHz Radar Transponder S.A.R.T.

Flashlight

Curtis Stokes & Associates, Inc.

1323 SE 17th Street Suite 168 Fort Lauderdale, Florida 33316 United States
Contact: Curtis Stokes, Phone: +1.954.684.0218, Email: curtis@curtisstokes.net
URL: <http://www.curtisstokes.net/>

Sweet Pea
Page 13

(4) Speed Line 250 Thrower

(1) Flare Kit with 10 Red Handheld Parachute Flare

(1) Signal Light

(1) Survival Kit Ditch bag: Water Maker, S.A.R.T., VHF, Sunscreen., Seasick tablets, Sunglasses, Hats, Flashlights, Lithium Batteries, Signal Mirror, Parachute signal rocket, Handheld GPS, Blankets, First AID kits, multi-tool, logbook, air horn, Fishing gear kit, Smoke signal and Sea dye.

Life Rafts, Rings, Jackets, & EPIRBS & Safety Gear

Life Rafts

- (2) 25-man life rafts located on sundeck. Each life raft is equipped with a hydrostatic release for automatic deployment or may be manually deployed.

MOB Tender: (Located on Sundeck) - New September 08

(1) Inflatable 10' Boat with Radar detector

- Compass & Search Light
- Hand Pump + Bailer
- Lifting Bridle
- Additional first AID kit
- Flashlight
- Repair Kit
- Towing Line
- Boat Hook
- Survival Blanket
- VHF
- 1 orange smoke signal canister, binoculars and a foghorn.

Life Rings

- Two rings (each with attached 15 min. orange smoke canister), mounted on the outboard side of the Wheel House. Smoke canister is activated when removed from mounting bracket.
- Two Rings w/ self activated light, located on each side of the main deck.
- Two Rings w/ throwing lines and lights located on each side of the main deck aft.
- Two extra Rings; 1 located on sun deck and the other is on port side boat deck by the tender bay.

EPIRBS:

- 406 MHz on top of the arch.

Life Jackets and Immersion Suits:

- (46) Adult Inflatable SOLAS Jackets
- (22) Adult immersion suits
- (1) Child Inflatable SOLAS Jacket

- (24) Jet ski vests
Flares Kit

Bosun Locker:

- (1) body splint kit with a extra leg and arm splint
- First AID Kit

Crew Hallway:

- (2) 15 minute breather packs
- Smoke hoods, (2) per crew cabin
- Inflatable PFD's , (2) per crew cabin
- Water tight doors
- Fire doors
- Escape Hatch

Master Cabin, Guest Cabins:

- (2) Smoke hoods per cabin
- 2 Inflatable PFD's per Cabin
- Fire Doors
- Water tight doors
- Escape Hatches (1 for the master stateroom and 1 for the guest stateroom areas)

Gym:

- Medical Supplies Chest,
- Advanced Medical Bag
- Medicine Box
- (2) Bottles of Oxygen
- A.E.D. (Heart Stream Defibrillator)
- (2) PFD's
- (2) Smoke Hoods

Engine Room:

- First aid Kit

S.O.P.E.P:

- (5) Oil Pads absorber with 100 units
- Oil Boom (150')
- (1) Hand Pump
- (2) Small soak booms
- Deck Drain plugs
- Foam Dispensing equipment

Exclusions

Artwork, china, glassware and crystal, etc., and all owner and crew personal items, knick knacks, photos, owner's dive gear, and DVD's, CD's, etc.

A detailed inventory list of exclusions will be provided pursuant to a purchase agreement.

The name *Sweet Pea* is reserved and must be changed.

All speeds, capacities, consumption, hours, measurements, etc. are approximate or estimated. Specifications provided for information only as particulars herein obtained are from sources available but are not guaranteed. Remarks and other statements may be personal opinions and may not be relied upon for purchase. Buyer should instruct his agent/supervisor to check all details for accuracy. Offered subject to prior sale, price/inventory change, or withdrawal from market without notice.

Disclaimer

The Company offers the details of this vessel in good faith but cannot guarantee or warrant the accuracy of this information nor warrant the condition of the vessel. A buyer should instruct his agents, or his surveyors, to investigate such details as the buyer desires validated. This vessel is offered subject to prior sale, price change, or withdrawal without notice.

Salon



Master Stateroom



Curtis Stokes & Associates, Inc.

1323 SE 17th Street Suite 168 Fort Lauderdale, Florida 33316 United States
Contact: Curtis Stokes, Phone: +1.954.684.0218, Email: curtis@curtisstokes.net
URL: <http://www.curtisstokes.net/>

Sweet Pea
Page 17

Skylounge



Sundeck



Curtis Stokes & Associates, Inc.

1323 SE 17th Street Suite 168 Fort Lauderdale, Florida 33316 United States
Contact: Curtis Stokes, Phone: +1.954.684.0218, Email: curtis@curtisstokes.net
URL: <http://www.curtisstokes.net/>

Sweet Pea
Page 18

Office/Study



Bow view



Curtis Stokes & Associates, Inc.

1323 SE 17th Street Suite 168 Fort Lauderdale, Florida 33316 United States
Contact: Curtis Stokes, Phone: +1.954.684.0218, Email: curtis@curtisstokes.net
URL: <http://www.curtisstokes.net/>

Sweet Pea
Page 19

Aft view



Master Bathroom



Curtis Stokes & Associates, Inc.

1323 SE 17th Street Suite 168 Fort Lauderdale, Florida 33316 United States
Contact: Curtis Stokes, Phone: +1.954.684.0218, Email: curtis@curtisstokes.net
URL: <http://www.curtisstokes.net/>

Sweet Pea
Page 20

Dining room



Guest Suite



Curtis Stokes & Associates, Inc.

1323 SE 17th Street Suite 168 Fort Lauderdale, Florida 33316 United States
Contact: Curtis Stokes, Phone: +1.954.684.0218, Email: curtis@curtisstokes.net
URL: <http://www.curtisstokes.net/>

Sweet Pea
Page 21

Wheelhouse



Curtis Stokes & Associates, Inc.

1323 SE 17th Street Suite 168 Fort Lauderdale, Florida 33316 United States
Contact: Curtis Stokes, Phone: +1.954.684.0218, Email: curtis@curtisstokes.net
URL: <http://www.curtisstokes.net/>

Sweet Pea
Page 22

Layout

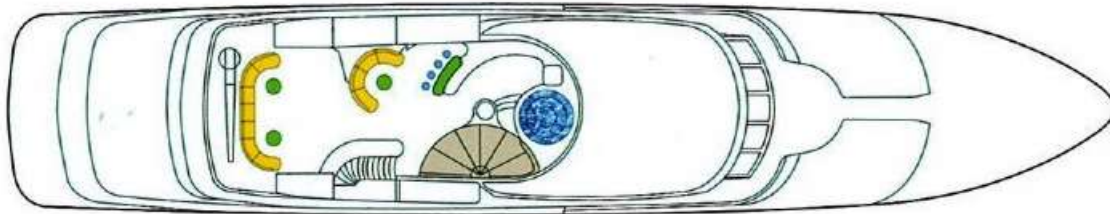

SUN DECK

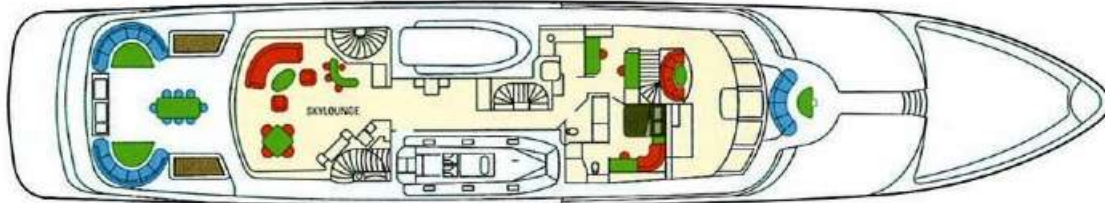

BRIDGE DECK

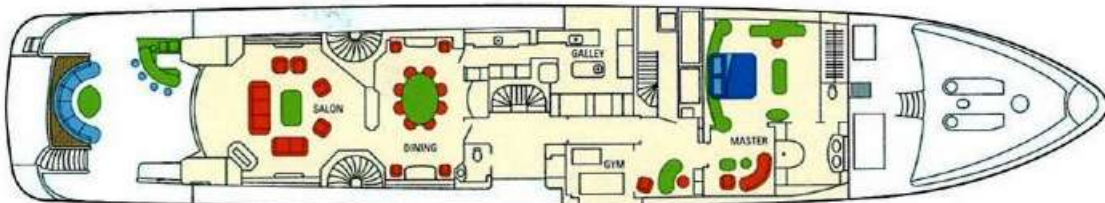

MAIN DECK

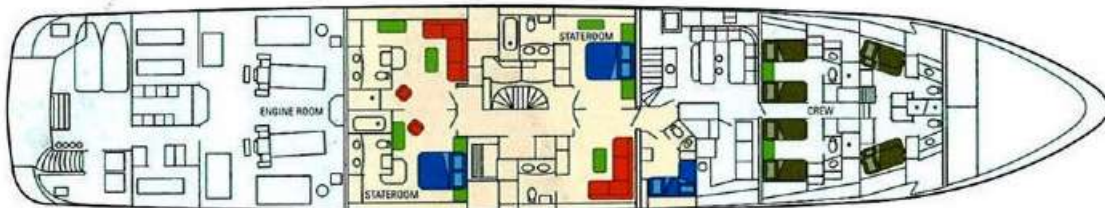

PLAN A FOR ACCOMMODATION DECK

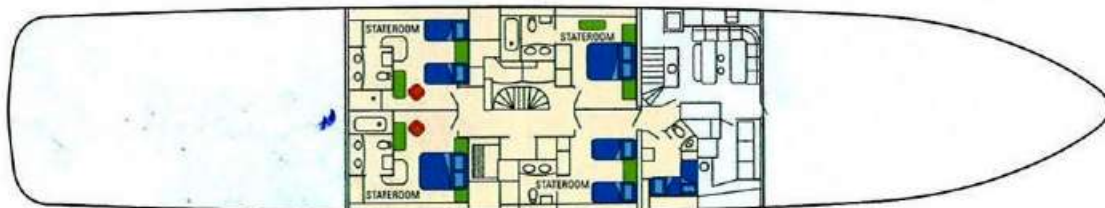

ALTERNATIVE PLAN B FOR ACCOMMODATION DECK